



## SUPPLEMENTAL CONVERSION INSTRUCTIONS FOR DESA DIRECT VENT FIREPLACES

### NATURAL GAS TO PROPANE/LP GAS

For Use When Converting Models Equipped with Conversion Ready Pilots

**⚠ WARNING:** This conversion kit must be installed by a qualified service agency in accordance with manufacturer's instructions and all applicable codes and requirements of authority having jurisdiction. If these instructions are not followed exactly, a fire, explosion, or production of carbon monoxide may result causing property damage, personal injury, or loss of life. A qualified service agency is responsible for proper installation of this kit. Installation is not proper or complete until operation of converted appliance is checked as specified in manufacturer's instructions supplied with kit.

These supplemental instructions apply to the following models produced after November, 2001 that are equipped with a conversion ready pilot system:

VDDVF36PN	VDVF36PN	DVF36	DVF36TA
VDDVF36STN	VDVF36STN	DVF36L	DVF36TLA
VDVF36TPNA	VDVF36TSTA	DVF36TMHPN	DVF36TMHST
DVF36TMHPNA	DVF36TMHSTA	MDVF36ST	MDVFST
BDVF36TLMHA	DVF42TLMHA	DVF32TMHPN	DVF32TMHST
DVF36PNA	DVF36TPNA	DVF36R	DVF36TLRA
DVF36STA	DVF36TSTA	DVF36D	BDVF36TLB
BDVF36	BDVF36TA	BDVF36LA	BDVF36TLA
BDVF36LB	DVF30	DVF30L	DVF42
DVF42L	DVF42D	DVF42TD	DVF42TA
GW30	GW30B	DVF42TDA	DVF42TLA
BDV37NC	CDV37NB	CHDV41NB	DDV41NB
BHDV37NC	CHDV37NMB	DVF34	DVFH34
BHDV37NCF	CHDV37NB	BDV34NB	BHDV34NB
BDV41NC	CDV41NB	CDV34NA	CHDV34NA
BHDV41NC	MDV37	MDV41	CHDV47NR

A conversion ready pilot system allows easy removal of pilot hood to access pilot orifice without breaking gas line connection to appliance.

If your model is not equipped with a conversion ready pilot, follow steps for conversion in main conversion instructions.

### IDENTIFYING EFFECTED MODEL

1. Locate model number on lighting instruction tag in lower control compartment of appliance.
2. Compare model number to list above.
3. If your model does not appear in list above, follow steps for conversion in main conversion instructions. If your model does appear in the list above, go to Pilot Orifice Conversion on back page.
4. If you are unsure of your model number or pilot system, you will need to examine the pilot to determine if it is conversion ready.

### IDENTIFYING PILOT

1. Follow instructions for accessing fireplace in main conversion instructions.
2. Locate pilot. Pilot is usually mounted at rear of burner assembly.
3. Compare your pilot to Figure 1. A conversion ready pilot has a retainer clip located under pilot hood (see Figure 1).
4. If your pilot has a retainer clip, continue on to Pilot Orifice Conversion on back page. If your pilot does not have a retainer clip it is not a conversion ready pilot. Follow steps for conversion in main conversion

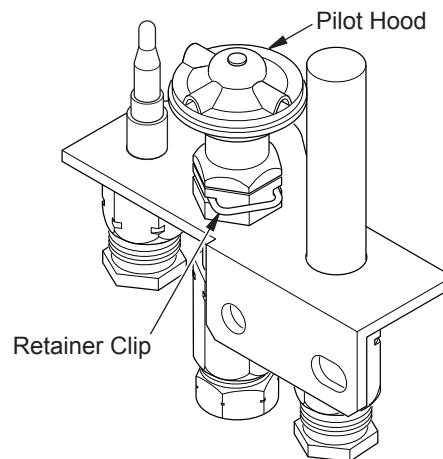
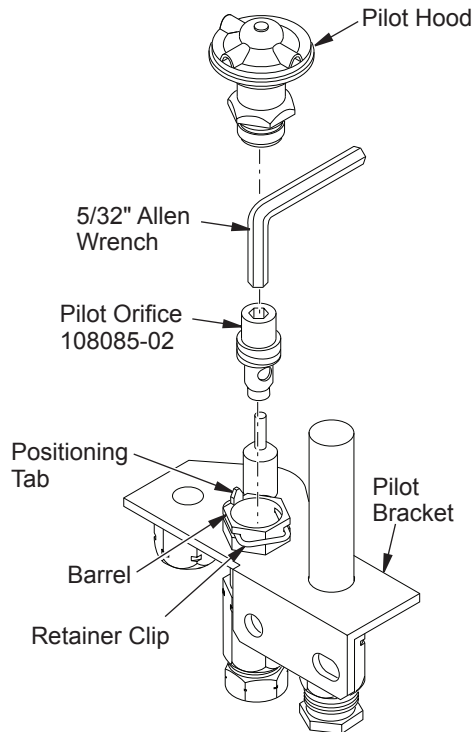

Figure 1 - Conversion Ready Pilot

## PILOT ORIFICE CONVERSION

1. Remove pilot hood assembly by pulling up until it disengages from barrel. Do not remove retainer clip (see Figure 2).
2. Remove pilot orifice from inside barrel using a 5/32" allen wrench.
3. Replace pilot orifice with orifice supplied with this kit with #30 stamped on sleeve. Insert small end of new pilot orifice into barrel and tighten with allen wrench.
4. Align notch on pilot hood assembly to positioning tab on barrel receiver and snap back into position.

**IMPORTANT:** Be careful not to bend or kink aluminum tubing during conversion. Make sure pilot hood and orifice are properly mated and aligned after finishing conversion.



**Figure 2 - Converting Pilot Orifice**

## COMPLETING CONVERSION

These supplemental instructions only apply to removal and replacement of pilot orifice. To complete this conversion, follow remaining instructions in main conversion instructions.

**⚠ WARNING: Test all piping and connections for leaks after installing or servicing. Correct leaks at once.**

**⚠ WARNING: Never use an open flame to check for a leak. Apply commercial leak detecting fluid to all gas joints. Bubbles forming show a leak. Correct all leaks at once.**



**HEARTH PRODUCTS™**

2701 Industrial Drive

P.O. Box 90004

Bowling Green, KY 42102-9004

[www.desatech.com](http://www.desatech.com)



109703 01

NOT A UPC

109703-01  
Rev. B  
05/07